



Rendition by Evanston artist Gay Riseborough

A New

*EVANSTON
WOMEN'S HISTORY
PARK*

in Downtown Evanston

Proposal – An Evanston Women’s History Park

The Premise:

Evanston holds a unique, vibrant, and intrinsic place in the history of women’s rights. We should honor, celebrate, and promote that fact.

Leading up to the ratification of the 19th Amendment in 1920, scores of early Evanston women were national leaders in the fields of education, law, theater, health, art, music, social welfare, literature, medicine, and social justice. Evanston buzzed with progressive, determined, audaciously activist women who changed their country and their world.

Evanston children should grow up understanding their city’s importance in the history of women’s rights. *Evanston should be known for its history of remarkable women.*

We could benefit economically from our legacy in women’s rights. [Other cities do.](#)

The Early Women of Evanston

The early women of Evanston were pioneers, innovators, and social reformers, tirelessly championing the rights, education, and welfare of women and children, transforming our cultural heritage.

Catherine Waugh McCulloch
Alice Bunker Stockham
Cornelia Gray Lunt
Isabella Garnett
Emily Huntington Miller

□ Elizabeth Wheeler Andrew - Jane Van Ettan Andrews - Clara Bell Baker - Edna Dean Baker □ - Josephine Turck Baker - Mary Bartelme - Marjorie Ayers Best - Helen Mar Judson Beveridge - □ Sarah Blaisdel Blanchard - Grace Jones Boring - Myra Colby Bradwell - Sarah H. Brayton - □ Katharine C. Bushnell - □ Margery Claire Carlson - Jessie Jane Chandler - Marguerite Stitt Church - Ethel Louise Coe - Elizabeth Washburn Crandon - □ Lois Mae Williams Davis □ - Caro Blymyer Dawes - Helen Palmer Dawes □ - Gladys Henry Dick □ - □ Mary Spencer Gardner - Isabella Maude Garnett - Louise Ayers Garnett □ - □ Mary Chaplin Glenn □ - Anna Adams Gordon - Anna Rew Gross - Melinda Truesdell Hamline - Elizabeth Boynton Harbert □ - Georgia Elma Harkness - Mary F. Geer Haskin - Frances Shapiro Herskovitz - Elizabeth Webb Hill □ - Mary Hyde Brown Hirt □ - Jane Currie Blaikie Hoge □ - Clara Ingram Judson □ - Kathryn Kidder - Bessie Cook Kingsley - Nellie Fitch Kingsley - Hurd Lord - Rosetta Wiege Lukey - □ Cornelia Gray Lunt □ - Nancy Carman Lutkin - Elizabeth Smith Marcy □ - Catharine Waugh McCulloch - □ Mary Eliza McDowell - Mary Gilruth McEwen - Kate Way McMullen - Anne George Millar - Emily Huntington Miller □ - Elizabeth Hawley Odell - □ Archange Chevallier Ouilmette - □ Hannah Bailey Pearsons - Eleanor Ellis Perkins - □ Lucy Fitch Perkins - □ Jessie L. Pocock - □ Catherine Gillespie Queal - □ Catherine Howard Reckitt - □ Alice Cushing Donaldson Riley - Maria Murray Robinson - □ Emma Winner Rogers - Eva Taylor Rouse - □ Minna Moschersch Schmidt - May Wood Simons - □ Carrie Crawford Smith - □ Louise L. Brockaway Stanwood - Alice Bunker Stockham - □ Eunice Hammond Tietjens - Mary Crowell Van Benschoten - □ Florence Dahl Walrath - □ Winifred Louise Ward - □ Cora Lee Banner Watson - □ Jane Hutchins White - □ Bertha Yerex Whitman - Frances Elizabeth Willard - Mary Bannister Willard - Helen Burnett Wood - Ida Faye Wright -

Early Evanston Women website: earlyevanstonwomen.org

The 'Brief Bios' page of the Early Evanston Women website highlights the accomplishments of twelve early Evanston women of diverse backgrounds who changed history.

The Evanston History Center has an extensive research database of early Evanston women.
Evanston Women’s History Project at the Evanston History Center: evanstonwomen.org

A Proposal:

Create an Evanston Women’s Park on the 1700 block of Chicago Avenue which includes the historically important Evanston Women’s Club and the Frances Willard House Museum. The streetside Women’s History Park would occupy the front third of the current Evanston Public Library parking lot.

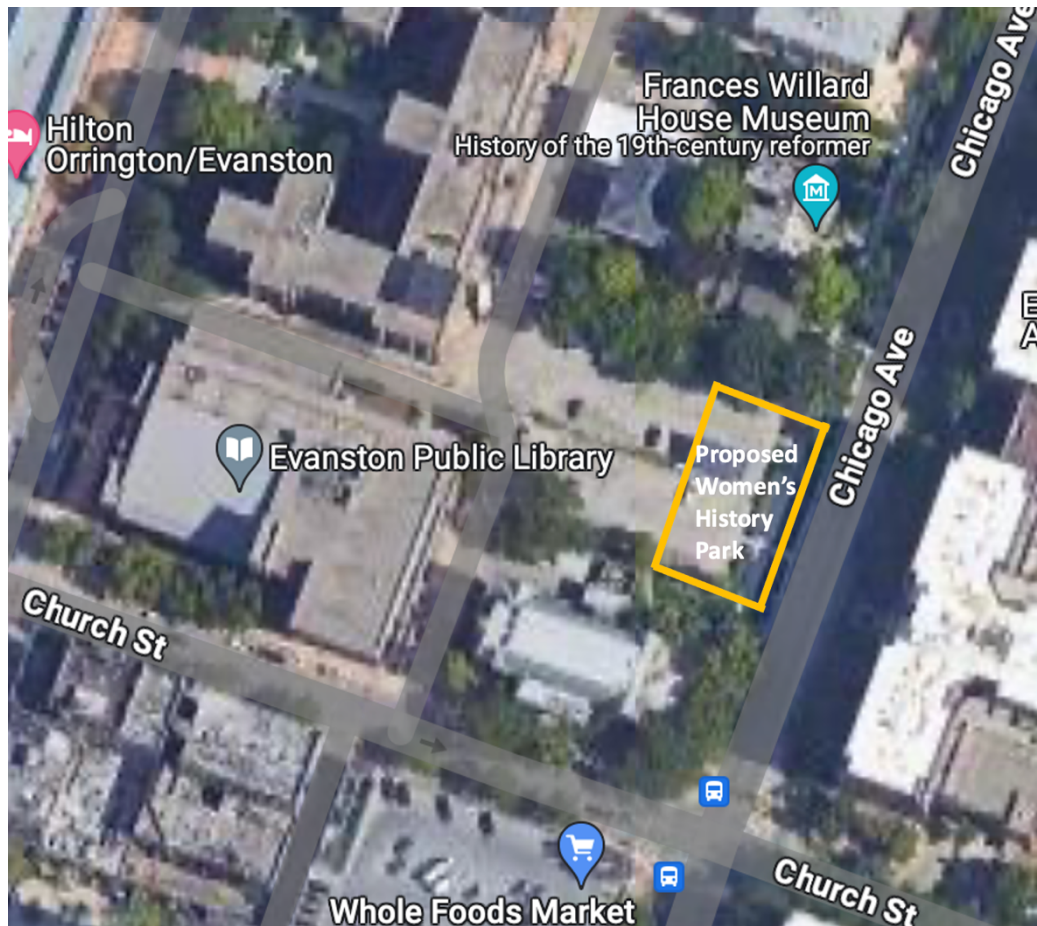

The new Evanston Women’s History Park would occupy a portion of the existing EPL parking lot. It would adjoin the historically important Evanston Women’s Club property and the Frances Willard House Museum properties.

A Problem:

The Evanston Public Library needs its parking lot. The solution: Reconfigure it.

The EPL parking lot utilizes nearly as much space for its driveways as it does for its 74 parking spaces. If it were reconfigured to utilize one-way drives with slant-in parking spaces, the number of spaces could be largely preserved within about 2/3 of the space (Evanston City Code 6-16-2-7). The remaining streetside space for the proposed park would measure about 60' by 150'.



The Current EPL Parking Lot



Existing EPL Lot Layout

[Evanston City Code for Parking Lot Configurations](#)

6-16-2-7. - OFF STREET PARKING DIMENSIONS.

- (A) The dimensions for parking stalls and associated aisles are set forth in Table 16-A of this Section.
- (B) The following exceptions to the dimensions set forth in Table 16-A of this Section shall apply:
1. Nonparallel parking stalls (those with a parking stall angle that exceeds 0 degrees) for which an abutting alley serves as a portion of an aisle need only be located with a minimum aisle (which may be partially comprised of driveways or public alleys) of thirteen (13) feet; provided that the application of said thirteen-foot minimum aisle width shall not result in a minimum parking stall setback from the alley lot line across which access to the stall is obtained, of less than two (2) feet, nor more than five (5) feet; and
 2. Parallel parking stalls (those with a 0 degree parking stall angle) for which an abutting alley serves as a portion of an aisle need only be located a minimum of two (2) feet from the alley lot line across which access to the stall is obtained.

Table 16-A Off-Street Parking Dimensions (in feet)

| Stall Type | Stall Width | Stall Length | Stall Angle | Minimum Aisle Width | Minimum Setback |
|-------------|-------------|--------------|-------------|---------------------|-----------------|
| Parallel | 8.0 | 18.0 | 0° | 10.0 | 2.0 |
| Parallel | 8.0 | 20.0 | 0° | 10.0 | 2.0 |
| Parallel | 8.0 | 22.0 | 0° | 10.0 | 2.0 |
| Parallel | 8.0 | 24.0 | 0° | 10.0 | 2.0 |
| Parallel | 8.0 | 26.0 | 0° | 10.0 | 2.0 |
| Parallel | 8.0 | 28.0 | 0° | 10.0 | 2.0 |
| Parallel | 8.0 | 30.0 | 0° | 10.0 | 2.0 |
| Parallel | 8.0 | 32.0 | 0° | 10.0 | 2.0 |
| Parallel | 8.0 | 34.0 | 0° | 10.0 | 2.0 |
| Parallel | 8.0 | 36.0 | 0° | 10.0 | 2.0 |
| Parallel | 8.0 | 38.0 | 0° | 10.0 | 2.0 |
| Parallel | 8.0 | 40.0 | 0° | 10.0 | 2.0 |
| Parallel | 8.0 | 42.0 | 0° | 10.0 | 2.0 |
| Parallel | 8.0 | 44.0 | 0° | 10.0 | 2.0 |
| Parallel | 8.0 | 46.0 | 0° | 10.0 | 2.0 |
| Parallel | 8.0 | 48.0 | 0° | 10.0 | 2.0 |
| Parallel | 8.0 | 50.0 | 0° | 10.0 | 2.0 |
| Parallel | 8.0 | 52.0 | 0° | 10.0 | 2.0 |
| Parallel | 8.0 | 54.0 | 0° | 10.0 | 2.0 |
| Parallel | 8.0 | 56.0 | 0° | 10.0 | 2.0 |
| Parallel | 8.0 | 58.0 | 0° | 10.0 | 2.0 |
| Parallel | 8.0 | 60.0 | 0° | 10.0 | 2.0 |
| Parallel | 8.0 | 62.0 | 0° | 10.0 | 2.0 |
| Parallel | 8.0 | 64.0 | 0° | 10.0 | 2.0 |
| Parallel | 8.0 | 66.0 | 0° | 10.0 | 2.0 |
| Parallel | 8.0 | 68.0 | 0° | 10.0 | 2.0 |
| Parallel | 8.0 | 70.0 | 0° | 10.0 | 2.0 |
| Parallel | 8.0 | 72.0 | 0° | 10.0 | 2.0 |
| Parallel | 8.0 | 74.0 | 0° | 10.0 | 2.0 |
| Parallel | 8.0 | 76.0 | 0° | 10.0 | 2.0 |
| Parallel | 8.0 | 78.0 | 0° | 10.0 | 2.0 |
| Parallel | 8.0 | 80.0 | 0° | 10.0 | 2.0 |
| Parallel | 8.0 | 82.0 | 0° | 10.0 | 2.0 |
| Parallel | 8.0 | 84.0 | 0° | 10.0 | 2.0 |
| Parallel | 8.0 | 86.0 | 0° | 10.0 | 2.0 |
| Parallel | 8.0 | 88.0 | 0° | 10.0 | 2.0 |
| Parallel | 8.0 | 90.0 | 0° | 10.0 | 2.0 |
| Parallel | 8.0 | 92.0 | 0° | 10.0 | 2.0 |
| Parallel | 8.0 | 94.0 | 0° | 10.0 | 2.0 |
| Parallel | 8.0 | 96.0 | 0° | 10.0 | 2.0 |
| Parallel | 8.0 | 98.0 | 0° | 10.0 | 2.0 |
| Parallel | 8.0 | 100.0 | 0° | 10.0 | 2.0 |
| Parallel | 8.0 | 102.0 | 0° | 10.0 | 2.0 |
| Parallel | 8.0 | 104.0 | 0° | 10.0 | 2.0 |
| Parallel | 8.0 | 106.0 | 0° | 10.0 | 2.0 |
| Parallel | 8.0 | 108.0 | 0° | 10.0 | 2.0 |
| Parallel | 8.0 | 110.0 | 0° | 10.0 | 2.0 |
| Parallel | 8.0 | 112.0 | 0° | 10.0 | 2.0 |
| Parallel | 8.0 | 114.0 | 0° | 10.0 | 2.0 |
| Parallel | 8.0 | 116.0 | 0° | 10.0 | 2.0 |
| Parallel | 8.0 | 118.0 | 0° | 10.0 | 2.0 |
| Parallel | 8.0 | 120.0 | 0° | 10.0 | 2.0 |
| Parallel | 8.0 | 122.0 | 0° | 10.0 | 2.0 |
| Parallel | 8.0 | 124.0 | 0° | 10.0 | 2.0 |
| Parallel | 8.0 | 126.0 | 0° | 10.0 | 2.0 |
| Parallel | 8.0 | 128.0 | 0° | 10.0 | 2.0 |
| Parallel | 8.0 | 130.0 | 0° | 10.0 | 2.0 |
| Parallel | 8.0 | 132.0 | 0° | 10.0 | 2.0 |
| Parallel | 8.0 | 134.0 | 0° | 10.0 | 2.0 |
| Parallel | 8.0 | 136.0 | 0° | 10.0 | 2.0 |
| Parallel | 8.0 | 138.0 | 0° | 10.0 | 2.0 |
| Parallel | 8.0 | 140.0 | 0° | 10.0 | 2.0 |
| Parallel | 8.0 | 142.0 | 0° | 10.0 | 2.0 |
| Parallel | 8.0 | 144.0 | 0° | 10.0 | 2.0 |
| Parallel | 8.0 | 146.0 | 0° | 10.0 | 2.0 |
| Parallel | 8.0 | 148.0 | 0° | 10.0 | 2.0 |
| Parallel | 8.0 | 150.0 | 0° | 10.0 | 2.0 |
| Nonparallel | 8.0 | 18.0 | 45° | 13.0 | 2.0 |
| Nonparallel | 8.0 | 20.0 | 45° | 13.0 | 2.0 |
| Nonparallel | 8.0 | 22.0 | 45° | 13.0 | 2.0 |
| Nonparallel | 8.0 | 24.0 | 45° | 13.0 | 2.0 |
| Nonparallel | 8.0 | 26.0 | 45° | 13.0 | 2.0 |
| Nonparallel | 8.0 | 28.0 | 45° | 13.0 | 2.0 |
| Nonparallel | 8.0 | 30.0 | 45° | 13.0 | 2.0 |
| Nonparallel | 8.0 | 32.0 | 45° | 13.0 | 2.0 |
| Nonparallel | 8.0 | 34.0 | 45° | 13.0 | 2.0 |
| Nonparallel | 8.0 | 36.0 | 45° | 13.0 | 2.0 |
| Nonparallel | 8.0 | 38.0 | 45° | 13.0 | 2.0 |
| Nonparallel | 8.0 | 40.0 | 45° | 13.0 | 2.0 |
| Nonparallel | 8.0 | 42.0 | 45° | 13.0 | 2.0 |
| Nonparallel | 8.0 | 44.0 | 45° | 13.0 | 2.0 |
| Nonparallel | 8.0 | 46.0 | 45° | 13.0 | 2.0 |
| Nonparallel | 8.0 | 48.0 | 45° | 13.0 | 2.0 |
| Nonparallel | 8.0 | 50.0 | 45° | 13.0 | 2.0 |
| Nonparallel | 8.0 | 52.0 | 45° | 13.0 | 2.0 |
| Nonparallel | 8.0 | 54.0 | 45° | 13.0 | 2.0 |
| Nonparallel | 8.0 | 56.0 | 45° | 13.0 | 2.0 |
| Nonparallel | 8.0 | 58.0 | 45° | 13.0 | 2.0 |
| Nonparallel | 8.0 | 60.0 | 45° | 13.0 | 2.0 |
| Nonparallel | 8.0 | 62.0 | 45° | 13.0 | 2.0 |
| Nonparallel | 8.0 | 64.0 | 45° | 13.0 | 2.0 |
| Nonparallel | 8.0 | 66.0 | 45° | 13.0 | 2.0 |
| Nonparallel | 8.0 | 68.0 | 45° | 13.0 | 2.0 |
| Nonparallel | 8.0 | 70.0 | 45° | 13.0 | 2.0 |
| Nonparallel | 8.0 | 72.0 | 45° | 13.0 | 2.0 |
| Nonparallel | 8.0 | 74.0 | 45° | 13.0 | 2.0 |
| Nonparallel | 8.0 | 76.0 | 45° | 13.0 | 2.0 |
| Nonparallel | 8.0 | 78.0 | 45° | 13.0 | 2.0 |
| Nonparallel | 8.0 | 80.0 | 45° | 13.0 | 2.0 |
| Nonparallel | 8.0 | 82.0 | 45° | 13.0 | 2.0 |
| Nonparallel | 8.0 | 84.0 | 45° | 13.0 | 2.0 |
| Nonparallel | 8.0 | 86.0 | 45° | 13.0 | 2.0 |
| Nonparallel | 8.0 | 88.0 | 45° | 13.0 | 2.0 |
| Nonparallel | 8.0 | 90.0 | 45° | 13.0 | 2.0 |
| Nonparallel | 8.0 | 92.0 | 45° | 13.0 | 2.0 |
| Nonparallel | 8.0 | 94.0 | 45° | 13.0 | 2.0 |
| Nonparallel | 8.0 | 96.0 | 45° | 13.0 | 2.0 |
| Nonparallel | 8.0 | 98.0 | 45° | 13.0 | 2.0 |
| Nonparallel | 8.0 | 100.0 | 45° | 13.0 | 2.0 |
| Nonparallel | 8.0 | 102.0 | 45° | 13.0 | 2.0 |
| Nonparallel | 8.0 | 104.0 | 45° | 13.0 | 2.0 |
| Nonparallel | 8.0 | 106.0 | 45° | 13.0 | 2.0 |
| Nonparallel | 8.0 | 108.0 | 45° | 13.0 | 2.0 |
| Nonparallel | 8.0 | 110.0 | 45° | 13.0 | 2.0 |
| Nonparallel | 8.0 | 112.0 | 45° | 13.0 | 2.0 |
| Nonparallel | 8.0 | 114.0 | 45° | 13.0 | 2.0 |
| Nonparallel | 8.0 | 116.0 | 45° | 13.0 | 2.0 |
| Nonparallel | 8.0 | 118.0 | 45° | 13.0 | 2.0 |
| Nonparallel | 8.0 | 120.0 | 45° | 13.0 | 2.0 |
| Nonparallel | 8.0 | 122.0 | 45° | 13.0 | 2.0 |
| Nonparallel | 8.0 | 124.0 | 45° | 13.0 | 2.0 |
| Nonparallel | 8.0 | 126.0 | 45° | 13.0 | 2.0 |
| Nonparallel | 8.0 | 128.0 | 45° | 13.0 | 2.0 |
| Nonparallel | 8.0 | 130.0 | 45° | 13.0 | 2.0 |
| Nonparallel | 8.0 | 132.0 | 45° | 13.0 | 2.0 |
| Nonparallel | 8.0 | 134.0 | 45° | 13.0 | 2.0 |
| Nonparallel | 8.0 | 136.0 | 45° | 13.0 | 2.0 |
| Nonparallel | 8.0 | 138.0 | 45° | 13.0 | 2.0 |
| Nonparallel | 8.0 | 140.0 | 45° | 13.0 | 2.0 |
| Nonparallel | 8.0 | 142.0 | 45° | 13.0 | 2.0 |
| Nonparallel | 8.0 | 144.0 | 45° | 13.0 | 2.0 |
| Nonparallel | 8.0 | 146.0 | 45° | 13.0 | 2.0 |
| Nonparallel | 8.0 | 148.0 | 45° | 13.0 | 2.0 |
| Nonparallel | 8.0 | 150.0 | 45° | 13.0 | 2.0 |

Current Configuration

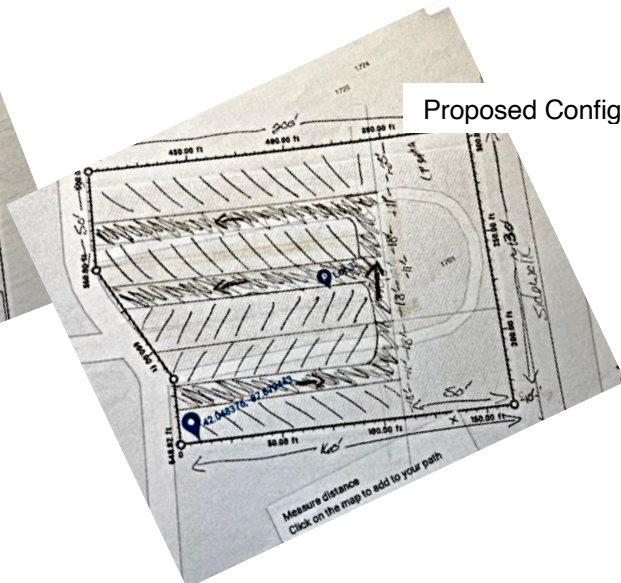
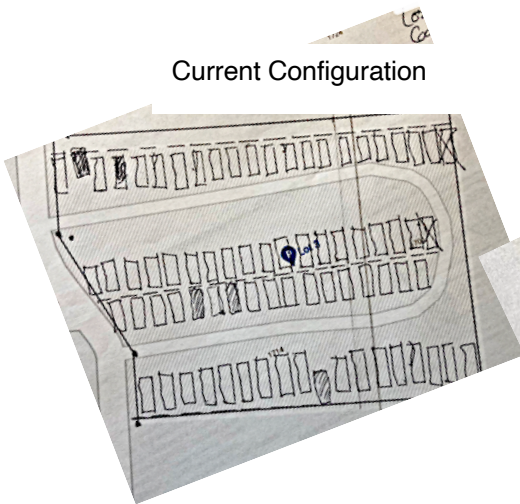

Proposed Configuration

Possibilities for a new Evanston Women's History Park:

A Sculpture – Evanston's WCTU commissioned the charming George Wade 'Little Water Girl' fountain sculpture in 1893, intending copies to be installed worldwide.

Copies of this sculpture exist in various locations, including at Lincoln Park in Chicago. (As of a few years ago, the Chicago Park District indicated that it would allow Evanston to have a mold made of the bronze sculpture/fountain without charge. No artist fees would be applicable for the sculpture.)

It is appropriate that a copy of this beautiful, historic sculpture be sited in Evanston, the home of the organization that commissioned it. *It belongs here.*

(The Little Water Girl was never given a name, but one of her attributes was said to be 'Kindness,' which could be an appropriate name for the Evanston installation of such a serene and welcoming sculpture. Or Evanston schoolchildren could select a name for her.)

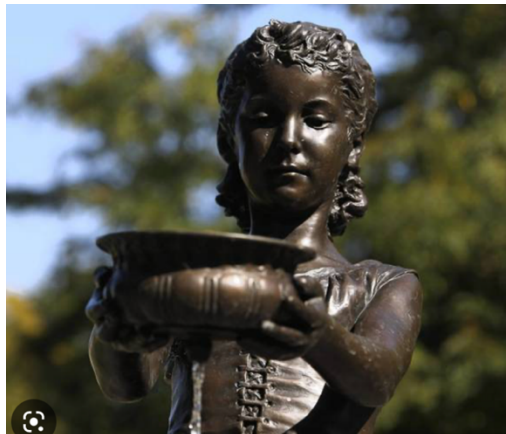

Little Cold Water Girl fountain in Lincoln Park: chicagoparkdistrict.com/parks-facilities/fountain-girl-artwork

Little Fountain Girl additional photos: smswsf.wordpress.com/2013/08/07/fountain-girl/

Historical background of the sculpture: chicagology.com/columbiaexpo/fair065/

Future Commissioned Sculptures – Isabella Garnett? Catharine Waugh McCulloch?

A Plaza – A plaza with pavers engraved with the names of the scores of historically important early Evanston women could serve as a gathering/event space and as lovely park adjoining Evanston's downtown business district.

The City could design something simple and lovely. The inclusion of dozens of early women's names would highlight the fact that many, many early Evanston women contributed importantly to U.S. history.

***EVANSTON SHOULD CELEBRATE ITS RICH
HERITAGE OF PIONEERING WOMEN!***